

Estates of Glenway

Tree Inventory Report



TABLE OF CONTENTS

1. INTRODUCTION
 - a. Client and Consultant
 - b. Scope of Work
2. OBSERVATIONS
 - a. General
 - b. Trees – Individuals and Groups
3. ANALYSIS
4. DISCUSSION
5. CONCLUSION(S)
6. RECOMMENDATIONS(S)

APPENDICES

- A LOCATION PLAN
- B SELECTED PHOTOGRAPHY
- C TREE CHARTS

1. INTRODUCTION

1. Tree Inventory Purpose

The Tree Inventory on the Estates of Glenway property was commissioned by Marianneville Developments. The purpose was to identify the number, sizes and health of trees, on the property in areas intended for redevelopment.

2. Property Description

The property is the lands of the former Glenway Golf Course and Clubhouse located in northwest Newmarket, ON. The scope of the inventory includes holes 1 to 11 inclusive and the lands around the clubhouse, parking and maintenance shed. The lands defined are east of the north-south



hydro corridor that strikes through the Glenway subdivision. The lands were developed as a golf course approximately 35 years ago, Residential properties were developed around and at the same time as the golf course construction. The lands are maintained by staff of the Glenway Golf Course.

3. Methodology

The tree inventory was performed by Mark Inglis, principal of York Urbanist, and Shan Tennyson, certified arborist, for all those lands within the property boundaries as shown on the plan(s) in Appendix A. The tree inventories took place on September 9 and 16, 2011. The weather was clear and above 20 degrees celcius. Photography of the trees and golf course lands took place on those days. A full compilation of photography is available from the consultant. Some photos are included in this report as part of Appendix B. The golf course superintendent was briefly interviewed about the progression of planting on the golf course. Locations of trees on adjoining properties within 4.5m are shown on the plans. All trees on the property were located based on topographic plans derived from air photography. Species of plants are given in botanical and common names in the charts enclosed as part of this inventory (Appendix C).

The sizes of the trees were determined primarily by measurement of the tree trunk at breast height. The average radius from the trunk to the branch canopy was also measured. Where a tree is newly planted, its height and location are identified. Multi-stem trees were assigned an approximate height and branch radius.



The health of each tree was determined from observation of its leaves, branches, trunk and exposed root conditions. A value of good, fair or poor was assigned to each live tree. Other observations might include the height, relationship to other vegetation or unusual growth habits. Definitions follow:

Good: The tree demonstrates little dieback to 10% of the growth. Colouration and form of the tree match typical tree specie and age characteristics. Limited evidence of insect infestation or disease exists.

Fair: The tree demonstrates more than 10% and less than 30% dieback. Colour and form may be different than a characteristic tree of its specie. Growth may be stunted or the tree may be leaning or trunk damaged. Leaves and trunk may evidence some insect infestation or disease that should not affect the future success of the tree.

Poor: The tree demonstrates more than 30% dieback of branches. Colour and form are much different from expected characteristics of the tree specie. Growth is hampered by soils, microclimate or maintenance. Major insect infestation or disease have deleteriously affected the growth of the tree. Trunk damage may be large, impeding future health of the tree.

2. OBSERVATIONS

1. General

Most trees in the subject lands are similar in age 30-35 years. Since the development of the golf course, trees have been transplanted from the golf course's nursery. The superintendent informed the consultant that significant numbers of plantings took place approximately 20 and 10 years ago, primarily coniferous plantings to help screen/protect adjoining



lands. The observations confirm these actions. Plant health sizes vary based on soils and microclimate conditions of the planting sites. There is limited variety of tree species. Because the lands are primarily manicured for golf purposes, little regeneration is taking place.

Remnants of the former farm field edges remain, an observation made based on the findings of mature apples and hawthorns between the green of Hole 1 and tee of Hole 2. These trees are in a row that is roughly parallel to and south of Davis Drive. A large and older ash exists on the left side of the fairway of Hole 2.

2. Trees – Individuals and Groups

Tree charts are available in Appendix C. The numbers are keyed to the plans in Appendix A. Botanical and common names are given for each tree. The tree size is given in diameter at breast height (dbh in cm) and the radii of the branches from the trunk are given in metres. Comments describe the quality of the tree in good, fair and poor. Reasons for the trees quality are often



described if there is visible fungal, insect or mechanical damage or characteristics uncommon to the specie. Trees are in groups where their proximity suggested such grouping.

3. DISCUSSION AND CONCLUSIONS

The golf course trees have limited diversity of species and size on lands that allow accessibility to each tree. Trees are predominantly located toward the property lines because the fairways, located centrally within the width of the lands, are clear of trees. Trees have been evidently planted to define the fairways for the golfers and to protect adjoining residential



properties from errant golf balls hit from the tees or fairways. The trees are sometimes located on berms that assist to protect the adjacent lands. Few trees exceed 35cm dbh. Most trees are non-native to Ontario with the exception of white ash, white pine, balsam fir, silver and sugar maples. Remnants of the former farm hedgerows have multiple stems and dense growth. Few areas of the golf course remain unmaintained.

4. CONCLUSION(S)

1. Opportunities exist to transplant some trees, particularly those planted in the past 20 years.
2. Where trees are located within areas not requiring grading, most trees will survive surrounding construction if properly protected.
3. No regionally rare plants were found on the subject property.
4. The next steps should include tree preservation, relocation and protection plans following preliminary design of the proposed housing.



Estates of Glenway

Tree Inventory Report

NOTES:

1. VERIFY ALL DIMENSIONS PRIOR TO CONSTRUCTION.
2. REPORT ALL DISCREPANCIES OR ERRORS, OMISSIONS OR DISCREPANCIES TO THE ARCHITECT OR DESIGNER AS SOON AS POSSIBLE.
3. USE ONLY LATEST REVISED DRAWINGS OR THOSE THAT ARE MARKED "ISSUED FOR CONSTRUCTION".
4. ARCHITECT AND/OR ENGINEER MUST BE RESPONSIBLE FOR THE ACCURACY OF ALL DIMENSIONS AND AREA CALCULATIONS ARE APPROXIMATE.

ISSUE / REVISION DESIGNATION

LETTER (A) = ISSUE, No.(1) = REVISION

No.	Date	Issued For / Revisions
1.	17/07/11	ISSUED FOR TSCA REVIEW

No.	Date	Issued For / Revisions

LEGEND
 WOODLAND EDGE PLANTING
 FASCINE

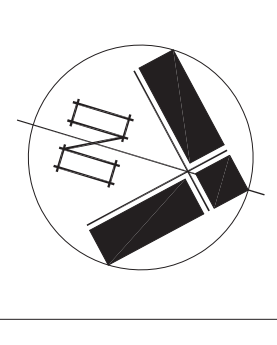
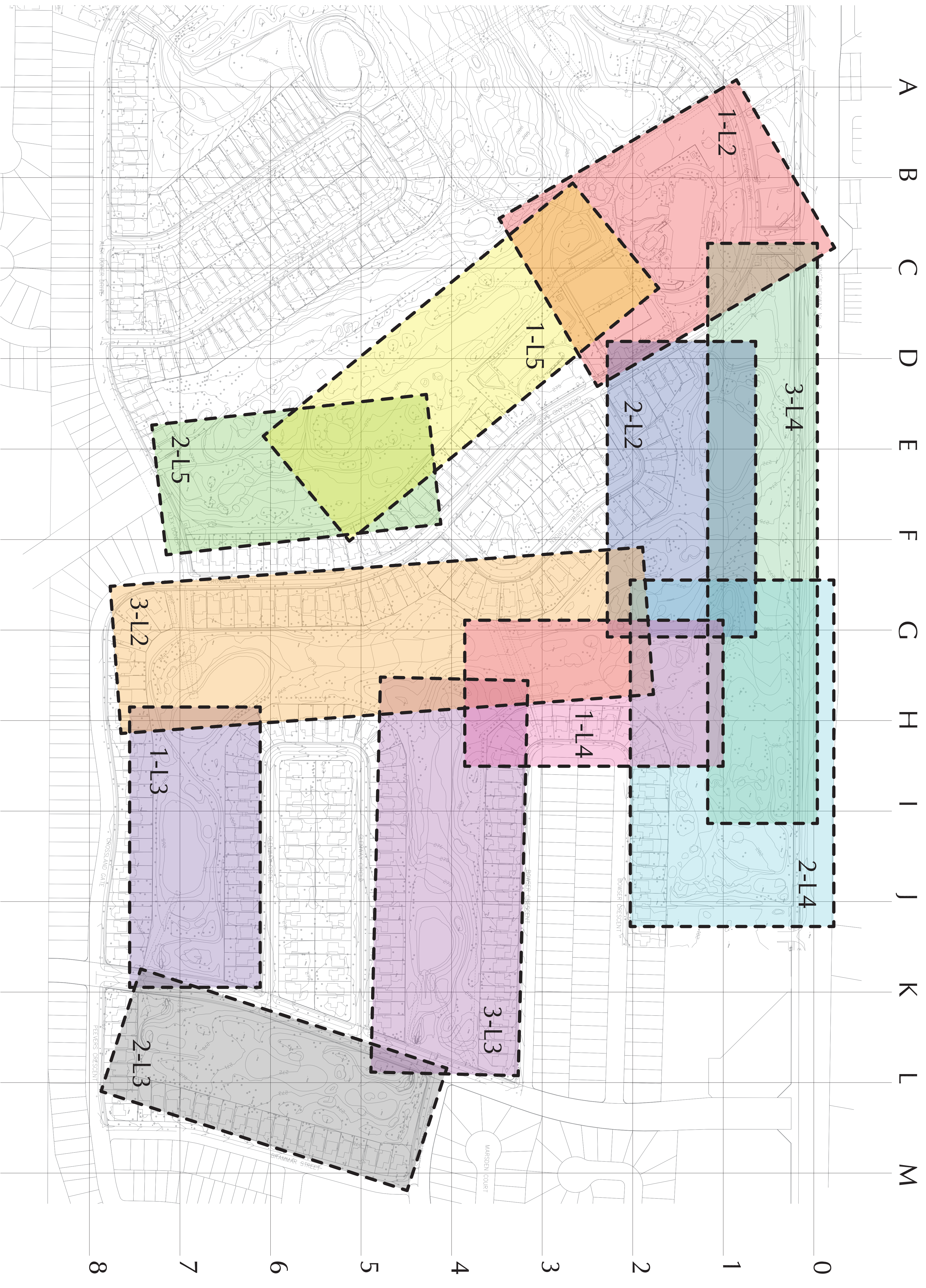

York Urbanist
 25 Main Street, Kelburne, ON, L0J 1C0
 905.881.2811 ext. 200
 www.yorkurbanist.com
 1416-771-8862

Project:
Marianneville Developments Ltd.
 Newmarket, Ontario, Canada

Drawing:
**TREE INVENTORY
 REFERENCE PLAN**

Drawn By	Job Captain	Project No.
EJV	HL	11001
Scale	As Noted	SJMA 1134
Proj. Date	19/09/2011	Sheet No.
Current Issue	1	L1

NOTES:

1. VERIFY ALL DIMENSIONS PRIOR TO CONSTRUCTION.
2. REPORT ALL DISCREPANCIES OR ERRORS, OMISSIONS OR DISCREPANCIES TO THE ARCHITECT OR DESIGNER.
3. USE ONLY THE LATEST REVISIONS OR THOSE THAT ARE MARKED "ISSUED FOR CONSTRUCTION".
4. ARCHITECT AND/OR ENGINEER AND MUST BE RETURNED TO THE ARCHITECT FOR THE PROJECT. ANY AREA CALCULATIONS ARE APPROXIMATE.

ISSUE & REVISION DESIGNATION
 LETTER (A) = ISSUE, No. (1) = REVISION

No.	Date	Issued For / Revisions
1.	23/08/11	ISSUED FOR SITE INVENTORY

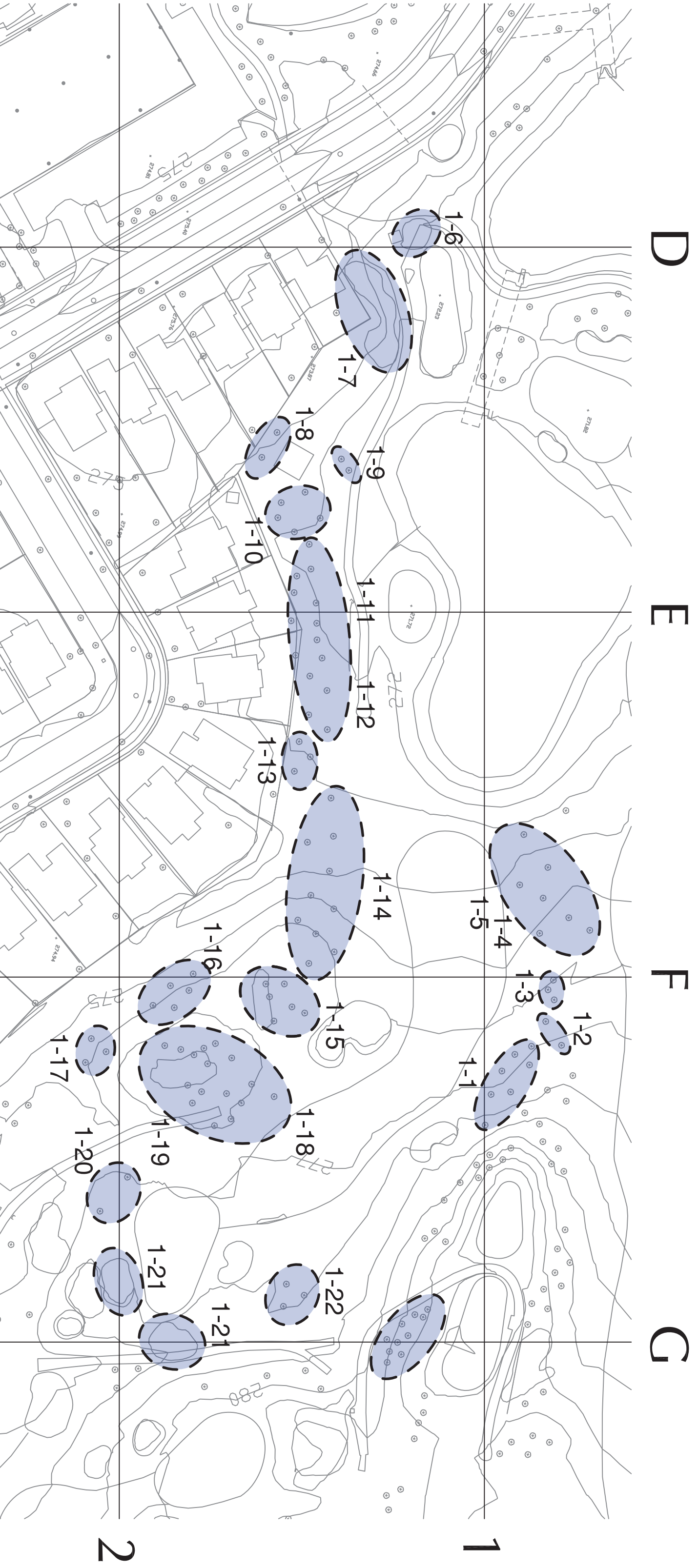

Hole 1 Plan
 scale: 1:1000

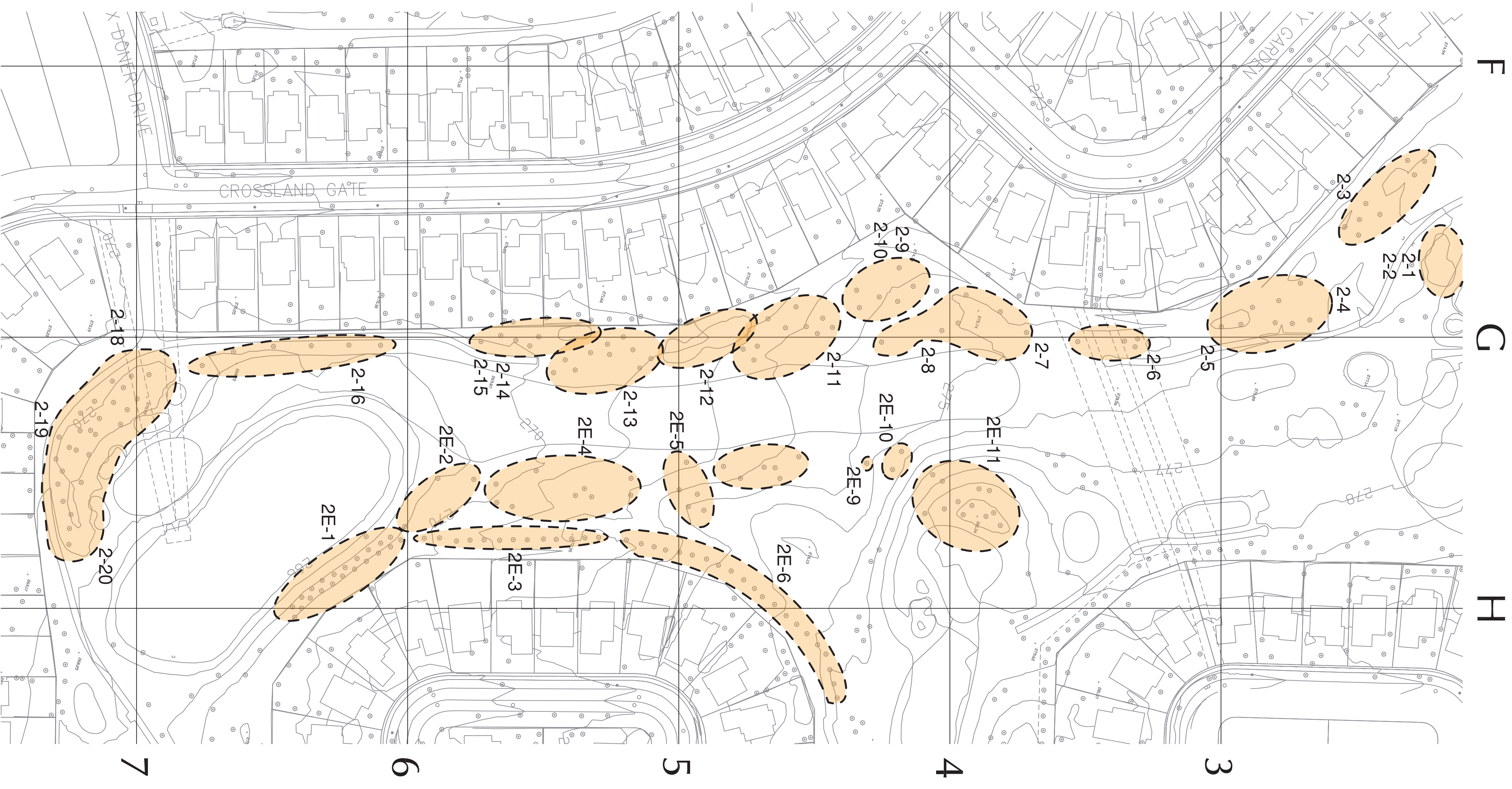

Hole 2 Plan
 scale: 1:1000

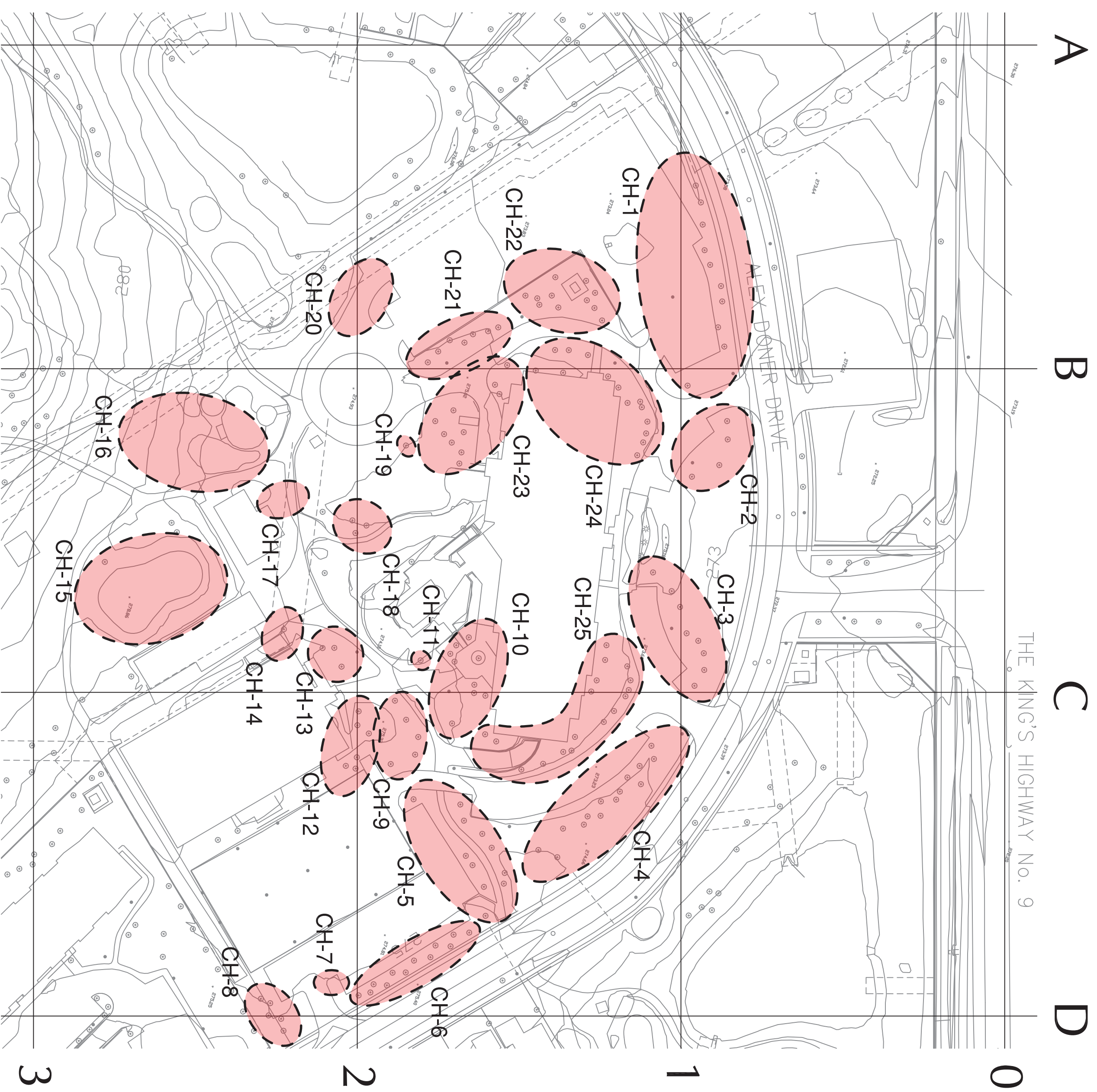

Club House Plan
 scale: 1:1000

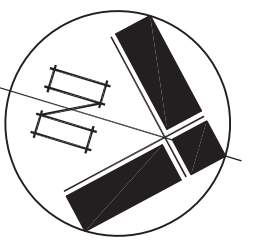

York Urbanist

25 Main Street, Kitchener, ON, L0J 1C0
 519.333.2111 ext. 2100
 519.333.2111 ext. 2100
 www.yorkurbanist.com

Project:
 Maranville Developments Ltd.
 Newmarket, Ontario, Canada

Drawing:
 Club House, Hole 1 & Hole 2

Drawn By: Job Captain
 EJV: H1
 Project No: 11001
 Scale: As Noted
 S/JMA 1142
 Sheet No:

Post Date: 19/09/2011
 Current Issue: 1
 Current Revision: L2

NOTES:

1. VERIFY ALL DIMENSIONS PRIOR TO CONSTRUCTION.
2. REPORT ALL DISCREPANCIES OR ERRORS, OMISSIONS OR DISCREPANCIES TO THE ARCHITECT OR DESIGNER AS SOON AS POSSIBLE.
3. USE ONLY LATEST REVISIONS OF DRAWINGS OR THOSE THAT ARE MARKED "ISSUED FOR CONSTRUCTION".
4. ARCHITECT AND/OR ENGINEER AND MUST BE RETURNED ON COMPLETION OF THE PROJECT. ANY CHANGES TO THE DRAWINGS MUST BE APPROVED BY THE ARCHITECT AND/OR ENGINEER.
5. AREA CALCULATIONS ARE APPROXIMATE.

ISSUE & REVISION DESIGNATION

LETTER (A) = ISSUE, No.(1) = REVISION

No.	Date	Issued For / Revisions
L	23/08/11	ISSUED FOR SITE INVENTORY



3 Hole 5 Plan Scale 1:1000

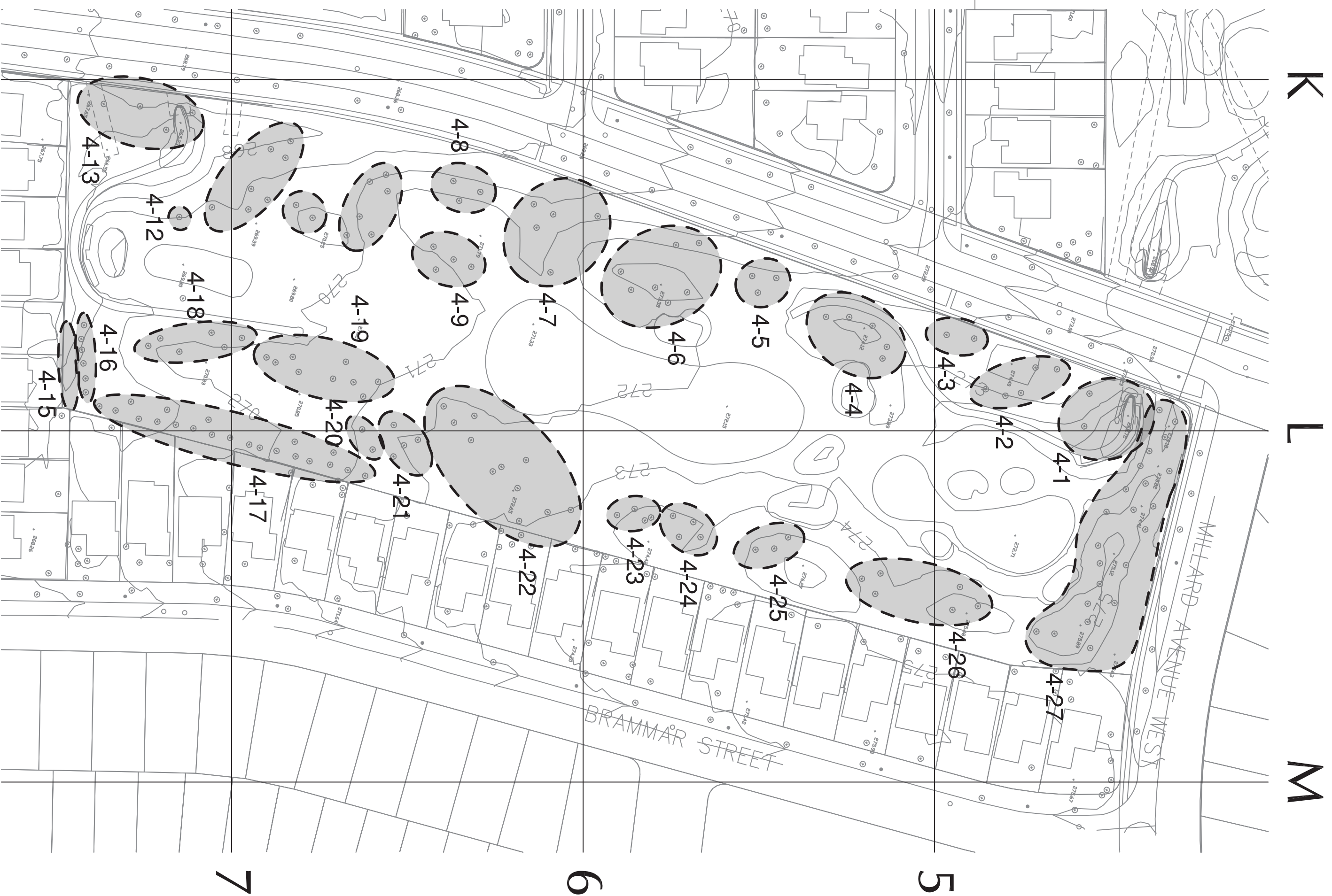

2 Hole 4 Plan Scale 1:1000



1 Hole 3 Plan Scale 1:1000

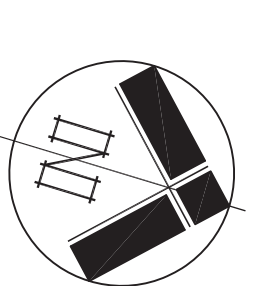

York Urbanist

25 Main Street, Kitchener, ON, L0J 1C0
 519.753.6100
 1418-2718882
www.yorkurbanist.com

Project:
 Maranville Developments Ltd.
 Newmarket, Ontario, Canada

Drawn:
 Tree Inventory
 Hole 3, Hole 4 & Hole 5

Drawn By	Job Captain	Project No.
EJV	TH	11001
Scale	As Noted	SJMA 1142
Proj. Date	19/09/2011	Sheet No.
Current Issue	1	Current Revision

Current Issue: 1
 Current Revision: L3

--

- NOTES:
1. VERIFY ALL DIMENSIONS PRIOR TO CONSTRUCTION.
 2. REPORT ALL DISCREPANCIES OR ERRORS, OMISSIONS OR DISCREPANCIES TO THE ARCHITECT OR DESIGNER.
 3. USE ONLY THE LATEST REVISED DRAWINGS OR THOSE THAT ARE MARKED "ISSUED FOR CONSTRUCTION".
 4. ARCHITECT AND/OR ENGINEER AND MUST BE RETURNED ON COMPLETION OF THE PROJECT. ANY AREA CALCULATIONS ARE APPROXIMATE.

ISSUE & REVISION DESIGNATION

LETTER (A) = ISSUE, No. (1) = REVISION	No.	Date	Issued For / Revisions
L	230811		ISSUED FOR SITE INVENTORY

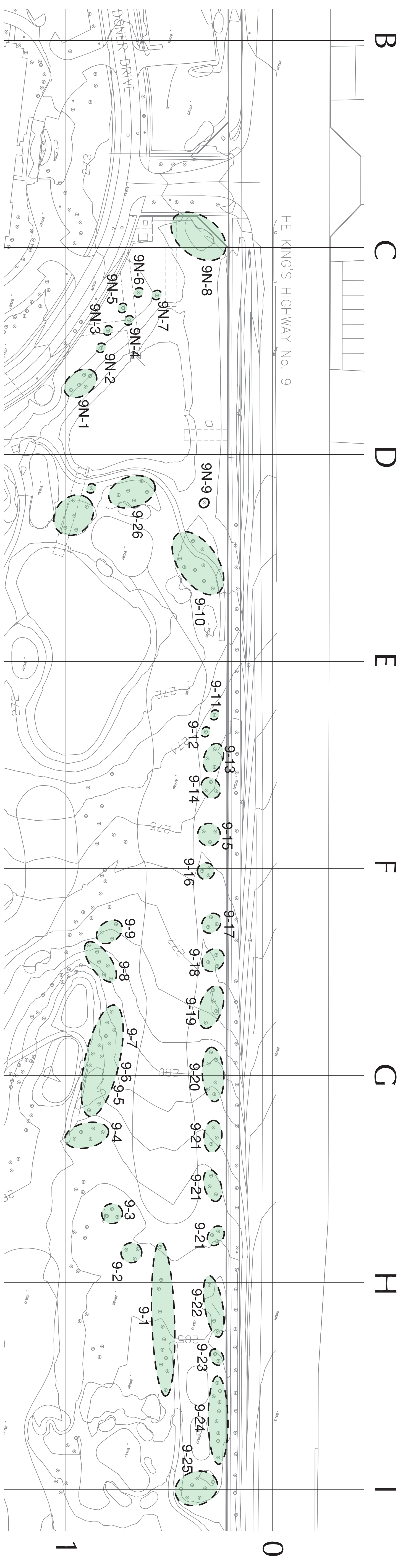

2 Hole 9 Plan scale: 1:1000



2 Hole 7 & 8 Plan scale: 1:1000

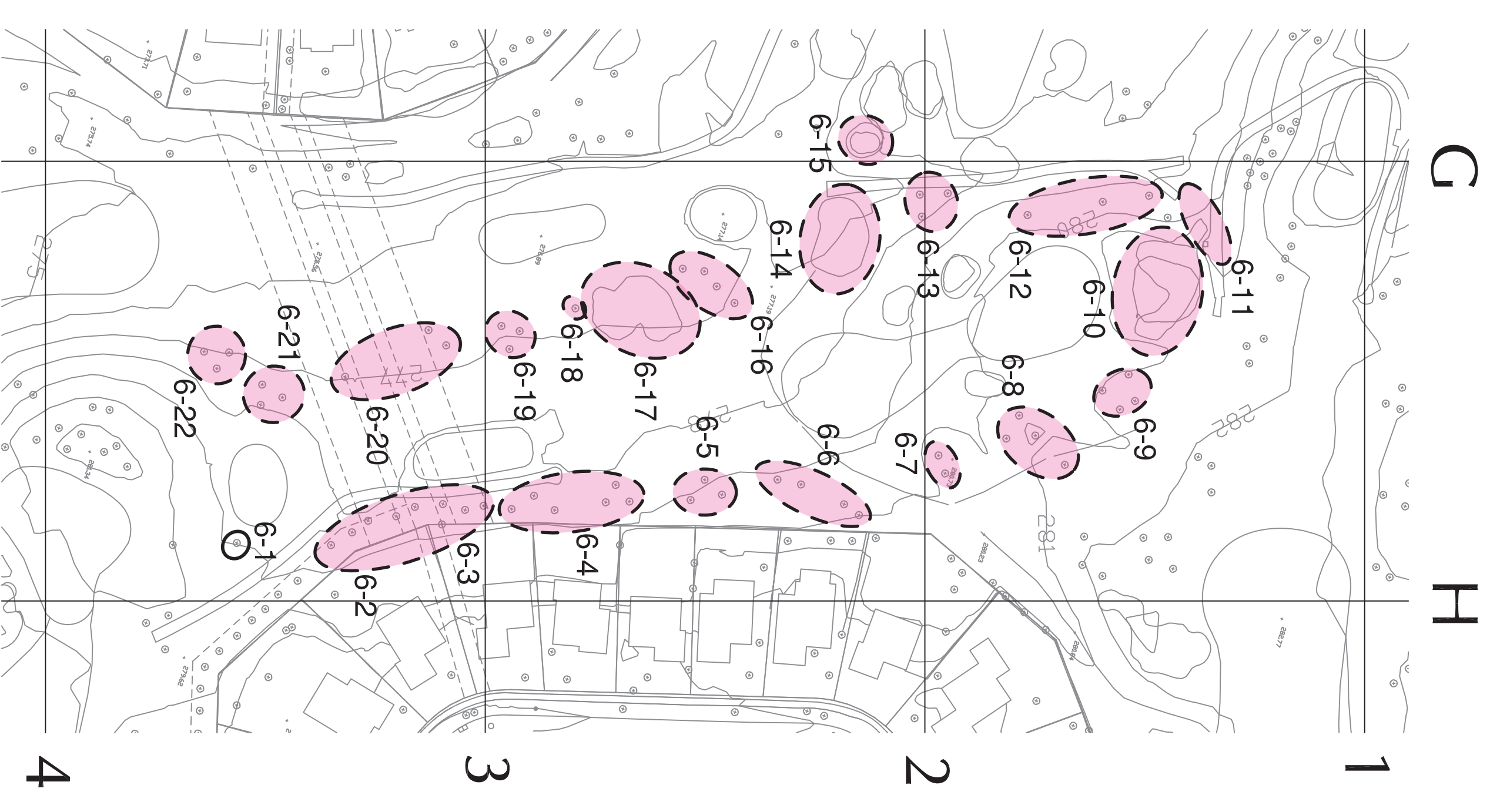

1 Hole 6 Plan scale: 1:1000

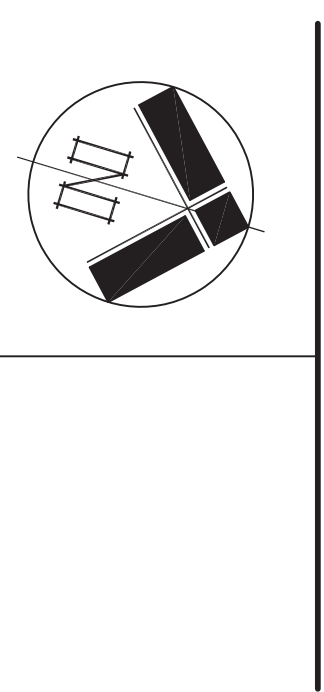

York Urbanist

25 Main Street, Keleynburg, ON, L0J 1C0
 905.875.8888
 www.yorkurbanist.com

Project: **Marianneville Developments Ltd.**
 Newmarket, Ontario, Canada

Drawn: **Tree Inventory**
 Hole 6, Hole 7, Hole 8 & Hole 9

Drawn By	Job Captain	Project No.
EJV	TH	11001

Scale: **As Noted**
 Project Name: **SJMA 1142**
 Project Date: **19/09/2011**
 Current Issue: **L4**

- NOTES:
1. VERIFY ALL DIMENSIONS PRIOR TO CONSTRUCTION.
 2. REPORT ALL DISCREPANCIES OR ERRORS, OMISSIONS OR DISCREPANCIES TO THE ARCHITECT OR DESIGNER AS SOON AS POSSIBLE.
 3. USE ONLY LATEST REVISIONS OF DRAWINGS OR THOSE THAT ARE MARKED "ISSUED FOR CONSTRUCTION".
 4. ARCHITECT AND/OR ENGINEER AND MUST BE RETURNED TO THE ARCHITECT OR ENGINEER.
 5. AREA CALCULATIONS ARE APPROXIMATE.

ISSUE & REVISION DESIGNATION

LETTER (A) = ISSUE , No.(1) = REVISION	No.	Date	Issued For / Revisions
L	1	19/09/11	ISSUED FOR SITE INVENTORY



Hole 11 Plan Scale: 1:1000

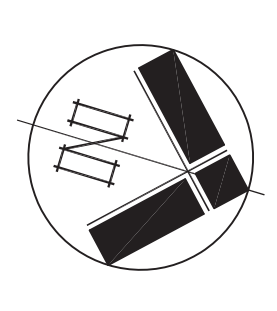

York Urbanist

25 Main Street, Kitchener, ON, L0J 1C0
 519.333.2111 ext. 200
 519.333.2111
 www.yorkurbanist.com

Project:
 Marianneville Developments Ltd.
 Newmarket, Ontario, Canada

Drawn:
 Tree Inventory
 Hole 10 & Hole 11

Drawn By	Job Captain	Project No.
EJV	TH	11001
Scale	As Noted	SJMA 1142
Proj. Date	19/09/2011	Sheet No.
Current Issue	1	Current Revision

Current Issue: 1
 Current Revision: L5



Estates of Glenway

Tree Inventory Report



HOLE 1



HOLE 2



HOLE 3



HOLE 4



HOLE 5



HOLE 6



HOLE 7



HOLE 8



HOLE 9



HOLE 10



HOLE 11



CLUBHOUSE



Estates of Glenway

Tree Inventory Report

ARBORIST REPORT

PROJECT NAME:
HOLE No.Estates of Glenway
Clubhouse

Tree No.	Species Botanical Name	Common Name	Qty	Size DBH (cm)	radius (m)	Condition
1	picea pungens	Colorado Spruce	6	15-25	3.0	good
	acer platanoides	Norway Maple	4	15.0	3.0	good; TS
2	quercus rubra	Red Oak	2	5.0	2.0	good
	fraxinus americana	White Ash	1	20.0	3.0	good
	picea pungens	Colorado Spruce	3	1@25, 2@2mht	1@3, 2@1m	good
3	quercus rubra	Red Oak	1	12.0	2.5	good
	quercus palustris	Pin Oak	3	22.0	4.0	good; minor dieback
	picea pungens	Colorado Spruce	2	8.0	6mht	good
	abies balsamea	Balsam Fir	2	8.0	6mht	good
4	picea pungens	Colorado Spruce	10	20.0	3.0	good
	acer saccharinum	Silver Maple	4	20.0	4.5	good;
5	picea pungens	Colorado Spruce	5	20.0	3.0	good
	acer saccharinum	Silver Maple	1	35.0	4.5	good;
	acer platanoides	Norway Maple	5	25.0	3.0	good; TS
6	picea pungens	Colorado Spruce	12	20.0	3.0	good
7	quercus rubra	Red Oak	1	5.0	1.0	good
8	picea pungens	Colorado Spruce	5	25.0	3.5	good
9	acer platanoides	Norway Maple	6	25.0	3.0	good; TS
10	chamaecyparis nootkatensis	Nootka False Cypress	3	8.0	3.0	good
	betula papyrifera	European Birch	1	20.0	3.5	good
11	acer platanoides	Norway Maple	1	25.0	3.0	good health, contorted growth
12	picea pungens	Colorado Spruce	6	20-25	3.5	good;
13	picea pungens	Colorado Spruce	3	20-25	3.5	good;
14	fraxinus americana	White Ash	1	25.0	4.0	good
15	malus sp	Apple	1	18.0	2.0	good health, pruned growth
	fraxinus americana	White Ash	2	15.0	3.0	good
16	malus sp	Crabapple	3	15.0	3.5	good;
17	acer saccharinum	Silver Maple	1	30.0	3.5	good
18	abies balsamea	Balsam Fir	1	30.0	3.0	good
	picea pungens	Colorado Spruce	2	30.0	3.0	good
19	acer platanoides	Norway Maple	1	12.0	2.0	good
20	malus sp	Crabapple	2	15.0	3.5	good;
21	acer platanoides	Norway Maple	2	18.0	3.0	good
	picea pungens	Colorado Spruce	5	20.0	3.0	good

22	fraxinus americana	White Ash	3	10.0	1.5	good
	acer ginnala	Amur Maple	2	multistem	2.5m ht	good
	picea pungens	Colorado Spruce	6	20.0	3.0	good
23	picea pungens	Colorado Spruce	9	20.0	3.0	8 good; 1 dead
24	picea pungens	Colorado Spruce	2	35.0	4.5	good
	malus sp	Crabapple	8	20-25	3.5	good;

Notes: DTB Diplodia Tip Blight
TS Tar Spot on leaves

ARBORIST REPORT

PROJECT NAME:
HOLE No.Estates of Glenway
1

Tree No.	Species Botanical Name	Common Name	Qty	Size DBH (cm)	radius (m)	Condition
1	fraxinus americana	White Ash	7	12.0	22.0	fair; lichen fungus
2	betula papyrifera	Paper Birch	2	10-15	3.0	fair; stunted growth; pruned to 3m
3	fraxinus americana	White Ash	3	12-20	3.0	fair; lichen fungus
4	acer platanoides Crimson King	Crimson King Maple	1	20.0	3.0	fair; TS; frost crack; fungus
	picea pungens	Colorado Spruce	2	25.0	3.0	fair; 20% dieback
5	fraxinus americana	White Ash	3	10-15	3.0	2 good; 1 poor - 60% dieback
	salix babylonica	Weeping Willow	1	30.0	3.0	good
6	pinus nigra	Austrian Pine	5	22-30	4.0	good; one leaning
7	pinus nigra	Austrian Pine	5	22-30	4.0	fair; 20% dieback
	picea pungens	Colorado Spruce	5	25-35	4.5	good
8	pinus nigra	Austrian Pine	2	25-35	3.5	fair; 30% dieback; one leaning
9	picea pungens	Colorado Spruce	2	22-30	3.0	good; one leaning; one is topped
10	pinus nigra	Austrian Pine	3	22-30	4.0	poor
	picea pungens	Colorado Spruce	2	20-30	4.0	good; dense group; internal branch dieback
11	pinus nigra	Austrian Pine	2	25.0	2.5	fair; one leaning; DTB
	abies balsamea	Balsam Fir	3	15-30	2-4	poor; 30% dieback; one leaning
12	pinus nigra	Austrian Pine	2	25-33	4.5	2 good; 1 poor; 1 dead
	abies balsamea	Balsam Fir	6	25-30	2-4	good; dieback on lower branches
13	acer saccharinum	Silver Maple	5	10-20	2-4	good; 2 succoring
14	fraxinus americana	White Ash	9	12-25	3-4	good; insect tear damage; surface roots; fungus
	acer saccharum	Sugar Maple	1	20.0	3.0	good; minor trunk damage
15	picea pungens	Colorado Spruce	3	25-33	3.0	good; one leaning;
	pinus nigra	Austrian Pine	3	25-33	4.5	2 fair; 1 poor - 30% dieback, no leader
16	acer saccharinum	Silver Maple	5	10-20	2-4	good; grouped
17	fraxinus americana	White Ash	7	10-20	2-4	good; fungus
18	acer saccharinum	Silver Maple	6	12-25	2-4	good; one succoring; one with minor trunk damage; roots exposed
	acer platanoides	Norway Maple	5	20-25	3-3.5	good; surface roots; trunk damage on one
19	picea pungens	Colorado Spruce	5	20-35	3-3.5	good; dense group
20	acer platanoides	Norway Maple	1	30.0	5.0	good; flare trunk; surface roots; TS
	acer saccharum	Sugar Maple	1	20.0	2.5	good
21	pinus nigra	Austrian Pine	5	35-45	4.5	good; minor trunk damage and DTB
22	acer saccharinum	Silver Maple	3	15-20	4.5-6	good; succoring

Notes: DTB
TSDiplodia Tip Blight
Tar Spot on leaves

ARBORIST REPORT

PROJECT NAME:
HOLE No.

Estates of Glenway
2

Tree No.	Species Botanical Name	Common Name	Qty	Size DBH (cm)	radius (m)	Condition
1	abies balsamea	Balsam Fir	4	2-4m ht	2.0	good; located on slope
2	betula pendula	European Birch	3	35.0	3.5	2 good; 1 poor 40% dieback
3	abies balsamea	Balsam Fir	13	5.0	3-4.5m ht	good
4	acer saccharinum	Silver Maple	9	15-35	4.0	good; pruned high; surface roots
5	acer saccharinum	Silver Maple	1	45.0	5.0	good
	fraxinus americana	White Ash	4	10-15	2-3	good; surface roots
6	abies balsamea	Balsam Fir	21	5-8	3-7mht	19 good; 2 fair
7	acer platanoides	Norway Maple	2	12.0	2.0	1 good; 1 poor
	acer saccharinum	Silver Maple	3	12-18	2-3.5	good
8	acer saccharinum	Silver Maple	1	dbl stem	2.5	fair; lichen fungus
9	fraxinus americana	White Ash	1	95.0	8.5	good; some dieback and insect damage on leaves
10	acer platanoides	Norway Maple	2	18.0	3.0	good; surface roots
11	pinus nigra	Austrian Pine	7	18.0	3.0	1 good; 6 poor; DTB
	picea pungens	Colorado Spruce	5	35.0	4.5	4 good; 1 poor; dieback and leaning
12						
13						
14						
15						
16						
17						
18						
19						
20						
21						

Notes: DTB Diplodia Tip Blight
TS Tar Spot on leaves

ARBORIST REPORT

PROJECT NAME:

Estates of Glenway

HOLE No.

2

Tree No.	Species Botanical Name	Common Name	Qty	Size DBH (cm)	radius (m)	Condition
1	malus sp.	Apple	3	2-4m ht	2.0	original farm hedgerow; trees overmature
	crateagus sp	Dotted Hawthorn	5	multistem		original farm hedgerow; trees overmature
2	prunus sp	Cherry	1	7.0		covered in vines - poor
3	acer saccharinum	Silver Maple	8	18-30	4.0	fair; succoring
4	abies balsamea	Balsam Fir	1	30.0	4.5	good
	populus tremuloides	Trembling Aspen	1	30.0	4.5	poor 30% dieback
5	fraxinus americana	White Ash	1	18.0	2.5	good
	acer saccharinum	Silver Maple	3	25-30	3-4	good; one succoring; one with frost crack
6	pinus nigra	Austrian Pine	2	30.0	3.0	poor 30% dieback
7	picea pungens	Colorado Spruce	1	35.0	3.5	good
	abies balsamea	Balsam Fir	5	30-35	3.0	good
8	pinus nigra	Austrian Pine	2	30-35	3.0	good; some DTB
	fraxinus americana	White Ash	1	15.0	3.0	good
9	acer saccharinum	Silver Maple	5	18-25	3.0	good; 2 succoring
	acer saccharum	Sugar Maple	1	multistem	4.5	good; unusual; trunk fungus
10	ostrya virginiana	Hophornbeam	1	5.0	3.0	good; growing together
	fraxinus americana	White Ash	1	15.0	3.0	
11	acer platanoides	Norway Maple	6	22-33	6.0	good; surface roots; TS
	abies balsamea	Balsam Fir	3	35.0	3.5	good
12	pinus strobus	White Pine	4	33-38	3.5	good
	picea pungens	Colorado Spruce	4	33-38	3.5	good
13	acer saccharinum	Silver Maple	5	20-30	3.5	good; 2 succoring
	pinus strobus	White Pine	3	20-30	3.5	good; one weeping out trunk
	abies balsamea	Balsam Fir	2	30.0	3.5	good
14	pinus nigra	Austrian Pine	2	30.0	3.5	good; 10 % dieback
	abies balsamea	Balsam Fir	4	25.0	3.5	3 good; 1 fair - 20% dieback
15	acer platanoides Crimson King	Crimson King Maple	1	20.0	3.0	good; trunk damage
16	tilia cordata	Littleleaf Linden	4	18-30	2.5-3	good; trunk damage
	abies balsamea	Balsam Fir	3	30.0	3.0	good

17	chamaecyparis nootkatensis	Weeping Nootka False Cypress	2	10.0	6m ht	good
18	fraxinus americana	White Ash	5	10-15	2.0	good
	acer saccharinum	Silver Maple	11	10-15	2.0	good, 2 with trunk damage; surface roots; succoring
19	abies balsamea	Balsam Fir	5	20.0	3.0	good
	picea pungens	Colorado Spruce	2	20.0	3.0	good
20	acer platanoides	Norway Maple	2	18.0	3.0	good
21						

Notes: DTB Diplodia Tip Blight
TS Tar Spot on leaves

ARBORIST REPORT

PROJECT NAME:
HOLE No.Estates of Glenway
3

Tree No.	Species Botanical Name	Common Name	Qty	Size DBH (cm)	radius (m)	Condition
1	abies balsamea	Balsam Fir	3	5m ht	2.0	good
	picea pungens	Colorado Spruce	2	30.0	2.5	good
2	picea omorika	Serbian Spruce	3	3m ht	1m	good
3	abies balsamea	Balsam Fir	4	35.0	3-4.5	good
4	abies balsamea	Balsam Fir	1	15.0	2.0	good
	picea omorika	Serbian Spruce	3	15.0	2.0	good
5	abies balsamea	Balsam Fir	1	15.0	2.0	good
	picea pungens	Colorado Spruce	2	15.0	2.0	good
6	fraxinus americana	White Ash	1	20.0	3.0	good
7	betula pendula	European Birch	2	30,35	3.0	1 good; 1 poor
8	picea pungens	Colorado Spruce	2	30-35	3.5	good
	abies balsamea	Balsam Fir	2	30-35	3.5	good
9	abies balsamea	Balsam Fir	3	30.0	3.5	2 good; 1 poor 40% dieback
	fraxinus americana	White Ash	1	12.0	3.0	good
10	acer platanoides	Norway Maple	1	18.0	3.0	good
	acer saccharinum	Silver Maple	2	12,25	2-3.5	good; succoring
11	pinus nigra	Austrian Pine	2	30.0	3.0	good
	acer platanoides	Norway Maple	3	30.0	6.0	good; surface roots
12	pinus nigra	Austrian Pine	7	30-35	5.0	6 good; 1 poor
	picea pungens	Colorado Spruce	3	35.0	5.0	good
13	pinus nigra	Austrian Pine	3	30-38	3-4.5	good
14	abies balsamea	Balsam Fir	3	30-35	5.0	2 good; 1 poor 40% dieback
	pinus nigra	Austrian Pine	3	35.0	4.5	2 good; 1 fair DTB
15	abies balsamea	Balsam Fir	2	35.0	3.0	good
	picea pungens	Colorado Spruce	1	30.0	2.5	good
16	abies balsamea	Balsam Fir	2	25-30	3.5	good; 1 leaning
17	picea pungens	Colorado Spruce	1	20.0	2.5	good
	fraxinus americana	White Ash	3	20.0	4.0	good
18	pinus nigra	Austrian Pine	5	30-38	3-4.5	good
	fraxinus americana	White Ash	2	15-20	4.0	good
19	picea pungens	Colorado Spruce	4	30-35	3.5	good
	acer platanoides Schwedleri	Schwedler Maple	1	18.0	2.5	good
20	betula pendula	European Birch	3	25-35	3.5	1 good; 1 fair; 1 poor
	abies balsamea	Balsam Fir	1	30.0	3.5	good
21						

Notes: DTB Diplodia Tip Blight
TS Tar Spot on leaves

ARBORIST REPORT

PROJECT NAME:
HOLE No.Estates of Glenway
4

Tree No.	Species Botanical Name	Common Name	Qty	Size DBH (cm)	radius (m)	Condition
1	pinus nigra	Austrian Pine	6	30-35	3.0	good
	acer platanoides	Norway Maple	2	8.0	2.5	good
2	acer saccharinum	Silver Maple	5	25-35	3.5	good; surface roots;
3	fraxinus americana	White Ash	2	25.0	3-4.5	good; fungus/lichen; frost damage
4	pinus nigra	Austrian Pine	4	30-35	3.0	good; minor dieback
5	fraxinus americana	White Ash	3	18.0	3.0	good
6	acer platanoides	Norway Maple	6	18-30	33.5	good;TS
	acer saccharum	Sugar Maple	1	18.0	2.5	good
7	acer saccharum	Sugar Maple	1	25.0	3.0	good; trunk damage
	acer saccharinum	Silver Maple	1	25.0	3.5	good
	fraxinus americana	White Ash	3	25-35	3.0	good
8	acer platanoides	Norway Maple	3	25-35	40667.0	good; TS
9	picea pungens	Colorado Spruce	4	30-35	3.5	good; one leaning
10	fraxinus americana	White Ash	3	21.0	3.0	good
	acer saccharinum	Silver Maple	3	25.0	3.5	good
11	pinus nigra	Austrian Pine	2	30.0	3.0	poor; misshapen
12	acer saccharinum	Silver Maple	7	20-25	4.5	good; 3 succoring
13	acer platanoides	Norway Maple	4	15-30	3-4.5	good; TS
14	picea pungens	Colorado Spruce	1	30.0	5.0	good
15	acer ginnala	Amur Maple	6	multistem		good; mature ht
16	abies balsamea	Balsam Fir	5	25-30	3.5	good;
	fraxinus americana	White Ash	1	20.0	4.0	good
17	abies balsamea	Balsam Fir	15	12.0	2.0	good; hedgerow on fence
	fraxinus americana	White Ash	6	20.0	4.0	good
18	acer saccharinum	Silver Maple	3	15-20	3.0	good; 3 succoring
	pinus nigra	Austrian Pine	3	20-30	4.0	good; DTB
19	acer saccharinum	Silver Maple	6	12-15	2.5	good; 3 succoring
	pinus nigra	Austrian Pine	3	25-30	4.0	2 good; 1 fair
20	abies balsamea	Balsam Fir	2	30.0	2.5	good
	picea pungens	Colorado Spruce	4	30-35	3.5	good
21	pinus nigra	Austrian Pine	3	30-35	3.0	1 good; 2 poor
	picea pungens	Colorado Spruce	1	30.0	3.5	good
22	fraxinus americana	White Ash	4	30-35	8.0	3 good; 1 poor
	acer platanoides	Norway Maple	6	26.0	3.0	good; TS
23	pinus nigra	Austrian Pine	2	18,30	4.5	1 good; 1 poor
	picea pungens	Colorado Spruce	1	35.0	4.5	good

24	acer saccharinum	Silver Maple	4	12-22	4.5	good; all succoring
25	picea pungens	Colorado Spruce	3	30-35	3.5	good
26	acer saccharinum	Silver Maple	3	25	3	good
	acer saccharum	Sugar Maple	3	20-25	5.5	good; succoring
27	pinus nigra	Austrian Pine	9	30-38	5	7 good; 2 poor
	picea pungens	Colorado Spruce	11	30-35	5	10 good; 1 poor
	acer platanoides	Norway Maple	2	33	5	good; TS

Notes: DTB Diplodia Tip Blight
TS Tar Spot on leaves

ARBORIST REPORT

PROJECT NAME:
HOLE No.Estates of Glenway
5

Tree No.	Species Botanical Name	Common Name	Qty	Size DBH (cm)	radius (m)	Condition
1	acer saccharinum	Silver Maple	6	12-15	2.5	good; 1 has damaged trunk; surface roots; 4 are succoring
2	acer platanoides	Norway Maple	2	30.0	3.5	good; surface roots; TS
3	pinus strobus	White Pine	18	20-30	3-4.5	16 good; 1 poor; 1 dead
	pinus nigra	Austrian Pine	4	28.0	3	poor; DTB
4	abies balsamea	Balsam Fir	16	25-35	3.5	good
	acer platanoides	Norway Maple	4	30.0	3.5	good; surface roots; TS
5	fraxinus americana	White Ash	2	15,30	3.5	fair; 30% dieback
	acer saccharum	Sugar Maple	3	12-20	4.5	good
6	larix laricina	Tamarack	1	35.0	4.0	good
7	acer saccharum	Sugar Maple	1	18.0	3.0	good
	acer platanoides	Norway Maple	1	22.0	4.0	good; fungus/lichen
8	abies balsamea	Balsam Fir	6	30-35	3.5	good; clumped
9	picea pungens	Colorado Spruce	9	30-35	3.5	good
10	abies balsamea	Balsam Fir	2	25-30	3.5	good; some branches damaged
11	pinus nigra	Austrian Pine	7	35-40	6.0	fair; 30% dieback
	acer saccharinum	Silver Maple	1	60.0	8.0	good
12	acer saccharinum	Silver Maple	1	50.0	7.0	good
13	abies balsamea	Balsam Fir	3	30-45	3.5	good
14	acer platanoides	Norway Maple	2	30.0	5.0	good; TS
15	acer saccharinum	Silver Maple	4	20-26	5.5	good; one has trunk damage
16	abies balsamea	Balsam Fir	8	25-30	3.5	good;
	pinus nigra	Austrian Pine	2	30-35	4.0	good
17	picea pungens	Colorado Spruce	7	30-35	3.5	good
18	abies balsamea	Balsam Fir	4	25-30	3.5	good;
	pinus nigra	Austrian Pine	4	30-35	4.0	good
19	picea pungens	Colorado Spruce	3	30-35	3-4	2 good; 1 poor
	fraxinus americana	White Ash	3	20.0	2.5	good; trunk damage
20	acer saccharinum	Silver Maple	3	15-18	2.5	good
	acer platanoides	Norway Maple	2	15-22	2.5	good; 2 succoring
21	abies balsamea	Balsam Fir	14	15.0	2.5	good; fence row
22	acer saccharinum	Silver Maple	3	20.0	3.5	good
23	acer platanoides	Norway Maple	1	15.0	2.5	fair; stunted growth
24						
25						

Notes: DTB Diplodia Tip Blight
TS Tar Spot on leaves

ARBORIST REPORT

PROJECT NAME:
HOLE No.Estates of Glenway
6

Tree No.	Species Botanical Name	Common Name	Qty	Size DBH (cm)	radius (m)	Condition
1	fraxinus americana	White Ash	1	25.0	3.0	good
2	fraxinus americana	White Ash	2	25.0	3.0	one poor; one good
3	picea pungens	Colorado Spruce	1	30	3.5	good
	pinus nigra	Austrian Pine	2	25-35	3	1 good; 1 fair - leaning
4	picea pungens	Colorado Spruce	3	25-35	3.5	good
	pinus nigra	Austrian Pine	3	25-35	3	2 good; 1 fair - dense group
5	picea pungens	Colorado Spruce	3	25-28	3.5	good
6	acer saccharinum	Silver Maple	2	25.0	4.0	good
	abies balsamea	Balsam Fir	1	25.0	3.5	good
	acer platanoides	Norway Maple	1	25.0	3.5	good
7	pinus nigra	Austrian Pine	2	30	3.5	1 good; 1 poor
8	acer platanoides	Norway Maple	4	30-35	3.5	good; TS; roots exposed
9	pinus nigra	Austrian Pine	3	35.0	3.5	1 good; 2 fair DTB
10	picea pungens	Colorado Spruce	4	35.0	3.5	good
	pinus nigra	Austrian Pine	3	35.0	4.5	good
11	thuja occidentalis	White Cedar	6	3m ht		good
12	acer platanoides	Norway Maple	4	22.0	2.5	good; TS
13	acer saccharinum	Silver Maple	3	25.0	3.0	good
14	crataegus punctata	Dotted Hawthorn	10	multi-stem		original farm hedgerow; declining
15	abies balsamea	Balsam Fir	2	25.0	3.5	good
16	picea pungens	Colorado Spruce	4	30-35	2-2.5	good
17	pinus nigra	Austrian Pine	4	30-35	3.0	3 good; 1 fair - multistem, no leader
18	acer platanoides	Norway Maple	1	25.0	3.5	good; TS
19	picea pungens	Colorado Spruce	3	30-35	3-4	good
20	acer saccharinum	Silver Maple	3	25-30	3.5	good; two succoring
21	pinus nigra	Austrian Pine	3	25-30	3.0	2 good; 1 fair - dense group
22	acer saccharinum	Silver Maple	3	15-25	3.5	good; one succoring
23						
24						
25						

Notes: DTB
TSDiplodia Tip Blight
Tar Spot on leaves

ARBORIST REPORT

PROJECT NAME:
HOLE No.Estates of Glenway
7

Tree No.	Species Botanical Name	Common Name	Qty	Size DBH (cm)	radius (m)	Condition
1	acer platanoides	Norway Maple	3	20	3	good; TS; fungus; surface roots
2	acer saccharinum	Silver Maple	3	12-18	3	good: surface roots
3	acer saccharum	Sugar Maple	2	15-20	3.5	good; fungus
4	acer saccharinum	Silver Maple	3	12-18	3	good: surface roots; one is succoring
5	acer platanoides	Norway Maple	3	25-28	3.5	good; TS; fungus; surface roots
6	acer saccharinum	Silver Maple	1	35	4	good
7	pinus nigra	Austrian Pine	13	25-35	3.5	4 good; 5 fair; 4 poor
8	picea pungens	Colorado Spruce	5	25-35	3.5	good; dense group
9	pinus nigra	Austrian Pine	2	35-45	4.5	good; dense group; DTB
10	abies balsamea	Balsam Fir	2	35	3.5	good
	acer platanoides	Norway Maple	2	25	3.5	good; tS; fungus; surface roots; trunk flare
11	pinus nigra	Austrian Pine	4	30 - 40	3.5	2 good; 2 fair - dead leader 40% dieback
	abies balsamea	Balsam Fir	4	30	3.5	good
12	abies balsamea	Balsam Fir	6	20-35	3-4	good
	acer platanoides	Norway Maple	4	20-35	2.5	good; tS; fungus; surface roots; trunk flare
13	acer platanoides Crimson King	Crimson King Maple	1	18	2.5	good; tS; fungus; surface roots; trunk flare
	fraxinus americana	White Ash	1	24	3.5	fair; 10% dieback; insects on leaves
14	abies balsamea	Balsam Fir	7	25-35	3-4	good
	pinus nigra	Austrian Pine	2	35	3.5	good; 20% dieback
15	acer saccharinum	Silver Maple	4	12-20	2-4.5	good; one succoring; one with tree cavity
16	fraxinus americana	White Ash	3	15-22	2-2.5	fair: leaning; insect damage; trunk damage; 20% dieback
17	acer ginnala	Amur Maple	3	6m ht		good
18	abies balsamea	Balsam Fir	4	25-30	1.5	good
19	abies balsamea	Balsam Fir	7	15-22	3-4	good
	acer platanoides Crimson King	Crimson King Maple	1	Jan-00	3.5	good; located on slope
20	acer saccharinum	Silver Maple	3	30-35	3.5	good; two succoring
21						
22						
23						
24						
25						

Notes: DTB
TSDiplodia Tip Blight
Tar Spot on leaves

ARBORIST REPORT

PROJECT NAME:
HOLE No.

Estates of Glenway
8

Tree No.	Species Botanical Name	Common Name	Qty	Size DBH (cm)	radius (m)	Condition
1	acer platanoides	Norway Maple	3	25-35	3-3.5	good; TS; fungus; surface roots
2	picea pungens	Colorado Spruce	3	30-35	2.5	good; one has 10% dieback
	pinus nigra	Austrian Pine	2	35	3	good
3	abies balsamea	Balsam Fir	3	8-20	30	good
	pinus nigra	Austrian Pine	3	24-30	2.5-3.5	one good; one poor due to DTB, 40% dieback
4	picea pungens	Colorado Spruce	4	30-35	2.5	3 good; one poor
	pinus nigra	Austrian Pine	3	24-30	3	2 good; 2 fair - leaning and DTB
5	fraxinus americana	White Ash	2	25	4.5	one good; one has trunk cavity at first branch - fair
6	picea pungens	Colorado Spruce	1	28	3	good
	pinus nigra	Austrian Pine	3	24-30	3.5	poor; 50% dieback
7	thuja occidentalis	White Cedar	4	10m ht		good
8	acer saccharinum	Silver Maple	3	25 -30	6	good; 20% dieback on one
9	picea pungens	Colorado Spruce	10	30-35	3	good
	pinus nigra	Austrian Pine	5	30	3.5	good; dense group
10	acer platanoides Schwedleri	Schwedler Maple	1	25	3	good
	acer ginnala	Amur Maple	2	multi-stem	6m ht	good
11	pinus nigra	Austrian Pine	4	30 - 40		healthy but leaning
12						
13						
14						
15						
16						
17						
18						
19						
20						
21						
22						
23						
24						
25						

Notes: DTB Diplodia Tip Blight
TS Tar Spot on leaves

ARBORIST REPORT

PROJECT NAME:

Estates of Glenway

HOLE No.

9 north

Tree No.	Species Botanical Name	Common Name	Qty.	Size DBH (cm)	radius (m)	Condition
1	acer platanoides Schwedleri	Schwedler Maple	5	12 - 15	2.5	4 good; one poor with trunk damage; TS
2						
3						
4	acer platanoides	Norway Maple	1	18	3.5	good; TS; fungus on trunk
5	fraxinus americana	White Ash	1	15	2.5	good
6	fraxinus americana	White Ash	1	15	2.5	good
7	acer platanoides	Norway Maple	1	12	2	poor; 25% dieback
8	acer platanoides	Norway Maple	3	15-28	4-5	fair; frost crack; fungus
	picea pungens	Colorado Spruce	3	15 - 25	2-3	poor; 25% dieback
9	picea pungens	Colorado Spruce	1	10&20	2.5	poor double trunk; 50% dieback
10	pinus nigra	Austrian Pine	6	25	4	fair; 20% dieback; DTB
	acer platanoides	Norway Maple	2	15-20	4	fair; two branches dead; TS
11	acer saccharum	Sugar Maple	1	15	2.5	fair; fungus/lichen; pruned to 3m
12	fraxinus americana	White Ash	1	15	4	good
13	acer saccharum	Sugar Maple	3	12-18	3.5	fair; road salt damage; pruned to 3m
14	pinus nigra	Austrian Pine	3	20 - 25	3	fair; DTB
15	acer platanoides	Norway Maple	3	dbl trunk	3	fair; dbl trunk; one trunk damaged; pruned to 3m
16	pinus nigra	Austrian Pine	3	20 - 25	3	fair; DTB
17	pinus nigra	Austrian Pine	3	20 - 25	3	fair; DTB
18	acer platanoides	Norway Maple	3	20 - 25	2-4	poor; TS; caterpillars; frost crack; trunk damage
19	pinus nigra	Austrian Pine	4	20 - 25	3	fair; DTB
20	acer platanoides	Norway Maple	6	20 - 25	2-4	5 good; 1 poor; TS; surface roots
21	pinus nigra	Austrian Pine	9	22-28	2-3	fair; DTB; one stunted; one has 50% dieback
22	picea pungens	Colorado Spruce	3	20-30	2.5	fair; leaning; 10% dieback
23	pinus nigra	Austrian Pine	2	22-28	2-3	fair; DTB; one has 20% dieback
24	pinus nigra	Austrian Pine	5	25	2-3	fair; DTB; one has 20% dieback
	picea pungens	Colorado Spruce	4	20-35	2.5-3.5	fair; leaning; 10% dieback; pruned to 1m
25	picea pungens	Colorado Spruce	7	25-30	2.5-3.5	fair; 10% dieback; one missing leader
26	acer platanoides	Norway Maple	6	25-30	4	5 good; 1 poor; TS; surface roots
27	betula pendula	European Birch	1	20	2	fair; trunk damage; surface roots; insect damage
28	chamaecyparis nootkatensis	Nootka False Cypress	1	10	6m ht	good
	picea pungens	Colorado Spruce	4	25-35	02-Apr	2 good; 2 poor with 30% dieback

Notes:

DTB

Diplodia Tip Blight

TS

Tar Spot on leaves

ARBORIST REPORT

PROJECT NAME:
HOLE No.

Estates of Glenway
9 south

Tree No.	Species Botanical Name	Common Name	Qty.	Size DBH (cm)	radius (m)	Condition
1	picea abies	Balsam Fir	11	35	3.5	10 good; 1 poor
2	acer saccharinum	Silver Maple	3	12 - 15	3	fair; fungus/lichen on trunk; one leaning; succoring; 10% dieback
3	picea pungens	Colorado Spruce	3	25	2.5	good
4	picea abies	Balsam Fir	2	25	3	good
	pinus nigra	Austrian Pine	3	25 - 30	3	fair; 20% dieback; DTB
5	acer ginnala	Amur Maple	4	5-7m ht		good
	picea abies	Balsam Fir	2	20-25	3	good
6	fraxinus americana	White Ash	2	25 - 30	4.5	good; insect damage on trunk; 10% dieback
	picea pungens	Colorado Spruce	3	22 - 30	4.5	good
7	acer platanoides Crimson King	Crimson King Maple	4	18 - 25	3	good; frost crack on one; pruned high; orange fungus; TS; surface roots
	pinus nigra	Austrian Pine	2	20 - 25	2.5	poor; one leaning; 30% dieback; DTB
8	acer saccharinum	Silver Maple	6	15 - 25	3.5 - 4.5	good; 10% dieback
9	picea pungens	Colorado Spruce	3	20 - 25	2.5	good
10						
11						
12						
13						
14						
15						
16						
17						
18						
19						
20						
21						
22						
23						
24						
25						

Notes: DTB Diplodia Tip Blight
TS Tar Spot on leaves

ARBORIST REPORT

PROJECT NAME: Estates of Glenway
 HOLE No. 10 east

Tree No.	Species Botanical Name	Common Name	Qty.	Size DBH (cm)	radius (m)	Condition
1	pinus nigra	Austrian Pine	1	30	3.5	good
2	acer platanoides	Norway Maple	1	20	4.5	poor; 40% dieback; damaged trunk
3	fraxinus americana	White Ash	3	13 - 15	4.5	good; fungus on trunk
	acer platanoides	Norway Maple	1	12	4.5	good; fungus on trunk; TS
4	pinus nigra	Austrian Pine	2	30	4.5	good
5	betula papyrifera	Paper birch	2	15	3	good
6	acer platanoides	Norway Maple	1	25	4.5	good; TS
	acer saccharinum	Silver Maple	3	45	5.5	good
7	acer platanoides	Norway Maple	1	35	4.5	good
8	fraxinus americana	White Ash	3	10 - 18	2.5 - 3.5	good; one is stressed due to root exposure
9	acer platanoides	Norway Maple	3	25 - 35	4.5	2 good; one poor due to trunk damage
	thuja occidentalis	White Cedar	6	3m ht	2	good
10	acer platanoides	Norway Maple	2	8 - 30	2 - 3.5	good; TS
	thuja occidentalis	White Cedar	3	3.5m ht	2	good
11	thuja occidentalis	White Cedar	1	2.5m ht.	1.5	good
	pinus sylvestris	Scots Pine	2	12	3	1 good; 1 poor
12	acer negundo	Manitoba Maple	1	18	3.5	good condition; poor specimen
	abies balsamea	Balsam Fir	1	5	2	good
13	acer platanoides	Norway Maple	3	25	4	good; TS
14	fraxinus americana	White Ash	7	10 - 30	2.5 - 4.5	good; fungus on trunk
15	acer saccharinum	Silver Maple	3	15 - 22	4.5 - 5	good; roots exposed
16	fraxinus americana	White Ash	6	15 - 25	2.5 - 4.5	good
17	abies balsamea	Balsam Fir	3	3m ht	1.5	good
	pinus nigra	Austrian Pine	1	3m ht	1.4	stunted growth; poor
18						
19						
20						
21						
22						
23						
24						
25						

Notes: DTB Diplodia Tip Blight
 TS Tar Spot on leaves

ARBORIST REPORT

PROJECT NAME:

Estates of Glenway

HOLE No.

10 west

Tree No.	Species Botanical Name	Common Name	Qty.	Size DBH (cm)	radius (m)	Condition
1	fraxinus americana	White Ash	4	15 - 30	2 - 5	good
2	pinus nigra	Austrian Pine	3	30	3.5	fair; some dieback
3	fraxinus americana	White Ash	1	15	3	good
	acer saccharinum	Silver Maple	3	15 - 25	6	good
4	fraxinus americana	White Ash	1	15	2.5	good
	acer saccharinum	Silver Maple	3	15 - 25	4.5	good
	acer platanoides	Norway Maple	2	18	2.5	good; TS
5	fraxinus americana	White Ash	3	15	2.5	good
	acer platanoides	Norway Maple	1	18	3.5	good
6	betula papyrifera	Paper Birch	1	18	3	good
7	fraxinus americana	White Ash	6	8 - 25	1 - 4	good; exposed roots
8	fraxinus americana	White Ash	3	10 - 12	1 - 2	good
9	pinus nigra	Austrian Pine	3	25 - 30	3.5 - 4.5	2 good; 1 poor; dieback DTB
10	acer saccharinum	Silver Maple	2	18	2.5	good
11	pinus nigra	Austrian Pine	2	30	2.5	poor
12	pinus nigra	Austrian Pine	2	30 - 35	4.2	fair; some dieback
	acer platanoides	Norway Maple	3	30	4 - 6	good; TS
13	pinus nigra	Austrian Pine	6	25 - 35	3	4 good; two poor
	acer platanoides	Norway Maple	3	30	3	good; TS
14	malus sp	Apple	3	20 - 40	5.5	good
15	pinus nigra	Austrian Pine	1	30	4.5	fair; some dieback; leaning
16						
17						
18						
19						
20						
21						
22						
23						
24						
25						

Notes: DTB
TS

Diplodia Tip Blight
Tar Spot on leaves

ARBORIST REPORT

PROJECT NAME:
HOLE No.Estates of Glenway
11

Tree No.	Species Botanical Name	Common Name	Qty	Size DBH (cm)	Condition
1	pinus nigra	Austrian Pine	2	40	good
2	acer platanoides Crimson King	Crimson King Maple	2	8	good
3	acer platanoides Crimson King	Crimson King Maple	2	8-20	good
4	malus sp.	Apple	3	15-20	good
5	pinus nigra	Austrian Pine	4	20 - 30	one poor; three good
6	acer saccharinum	Silver Maple	1	30	good
7	fraxinus americana	White Ash	6	Aug-20	good; roots exposed
8	pinus nigra	Austrian Pine	4	25 -30	healthy but stunted with some dieback
9	acer saccharinum	Silver Maple	1	40	good; roots exposed
10	fraxinus americana	White Ash	1	15	good
11	pinus nigra	Austrian Pine	4	30 - 40	healthy but leaning
12	acer saccharinum	Silver Maple	1	22	good
13	fraxinus americana	White Ash	2	Dec-20	good
14	acer saccharinum	Silver Maple	1	28	good
15	pinus nigra	Austrian Pine	2	35	1 fair; 1 good
16	acer platanoides	Norway Maple	2	30	TS; roots expose; good
17	acer saccharinum	Silver Maple	3	20 - 28	good; two are succoring
18	pinus nigra	Austrian Pine	2	35 - 40	one good; one poor due to DTB
19	acer platanoides	Norway Maple	3	30 - 32	good; TS; Roots exposed
20	pinus nigra	Austrian Pine	2	32	good
21	acer platanoides	Norway Maple	3	30	good; TS
22	pinus nigra	Austrian Pine	2	30 - 35	one poor; one fair; DTB; dieback
23	acer saccharinum	Silver Maple	2	12 - 15	good; minor trunk damage; succoring on two
24	fraxinus americana	White Ash	3	15	good
25					

Notes: DTB Diplodia Tip Blight
TS Tar Spot on leaves